



14+



5



2,05m



1 = 2,02m
2 = 1,4m
3 = 3m

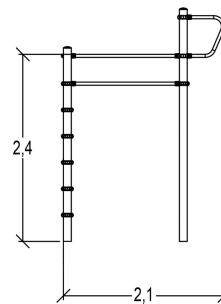
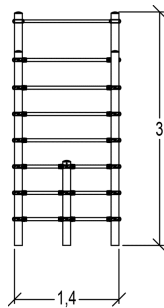

Elementos constituyentes

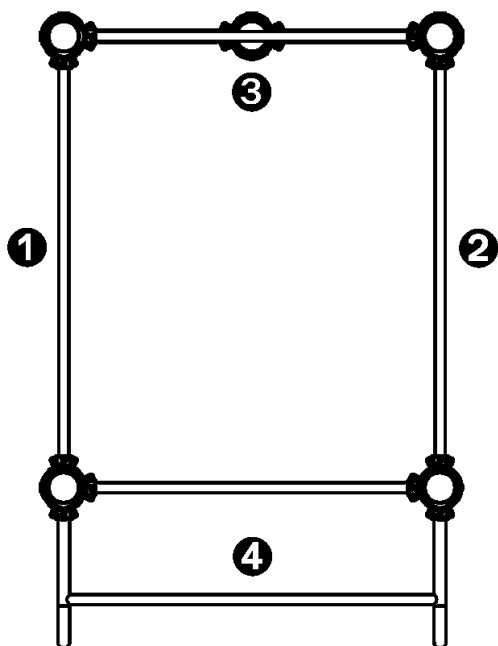

- ① Horizontal bar L:1.25m
- ② Horizontal bar 2.40m
- ③ Wall bars
- ④ Pull-up bar

Instalación del equipamiento

Zona de impacto: Superficie de suelo mínima requerida

- Zona de impacto
- Espacio libre

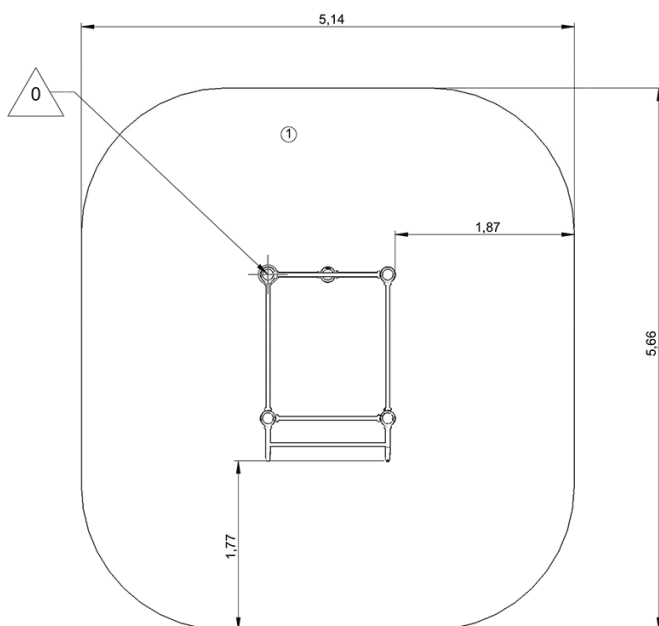

1	2,05m	27,5m ²



2



2h30



0.7m³



27.5m²



170kg



28kg

